

LOGIN GUIDE

This login guide provides the specific login information for your device. Please refer to the manual for all information on using myDiabby Healthcare*.



NFC connection for NovoNordisk NovoPen 6 and Echo Plus pens

Data transfer is done using the NFC antenna by bringing the insulin pen close to your smartphone.

- 1 Enable NFC on your smartphone** (in the settings) - on some smartphones, NFC is enabled by default and cannot be disabled
- 2 Log in to the myDiabby application and open the "My connected objects" tab**
- 3 Select "Connect an insulin pen connect system".**

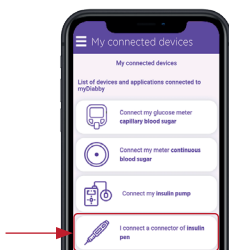
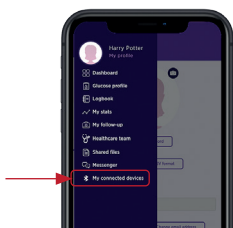

- 4 Select "Novo Nordisk NovoPen® 6/NovoPen Echo® Plus Insulin Pen", then click on "Connect my device".**

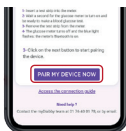
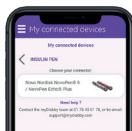

- 5 The search is underway:**
 - On Android, bring the insulin pen close to your smartphone at the NFC spot.
 - On iPhone, bring your insulin pen close to the NFC spot. Your iPhone will vibrate once the pen is detected and a confirmation will appear on the screen.

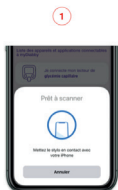

A pop-up will appear with a progress bar: the pen is detected, Do not move the pen transfer time

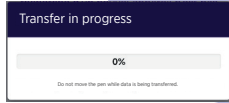

6 Select your pen and confirm your choice.



7 Select the insulin type of your pen: **all compatible insulins** will be shown in the list.



8 Your pen appears connected, press Click **"Sync"** to restore the data apply to the pen by repeating **step 5**.

Your data is synchronized with your myDiabby Healthcare account!



If you have gestational diabetes:

If you have gestational diabetes: once the blood sugar level appears on the myDiabby application, **CHECK** or **VERIFY** the time of day so that the result is in the right place in the logbook. You can **add comments** or insulin doses.

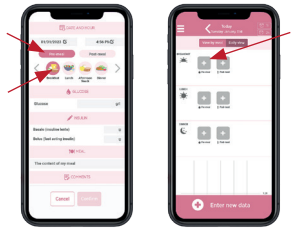

Daily use

- 1** Login to the myDiabby application
- 2** open the **"My connected objects"** tab
- 3** At the pen you have connected, press **"Synchronize"**.
- 4** **Move your insulin pen towards the NFC antenna** of your smartphone until you feel a vibration or hear a confirmation sound
- 5** Then **complete the data** retrieved to view it in your logbook.

If you have any questions about the myDiabby application: support@mydiabby.com or by phone

France : 01 76 40 01 78

Belgique : 02 320 11 96



MDHC SAS
66 avenue des Champs Elysées
75008 Paris
FRANCE

*The manual is available for download and consultation on the myDiabby Healthcare platform.



0459

Document applicable from version 2.25 of myDiabby Healthcare