



## LOGIN GUIDE

This login guide provides the specific login information for your device. Please refer to the manual for all information on using myDiabby Healthcare\*.

### Linking the meter with the myDiabby application

- 1** Download the 2 applications myDiabby and mylife to the phone. Log in to each of the 2 applications. The mylife application collects data from the Ypsopump insulin pump. Mylife will then automatically send the data to myDiabby Healthcare, which is the application that connects you with your healthcare team.



- 2** Connect the Unio Neva blood glucose meter to the mylife app via Bluetooth by following the meter guide.

- 3** Log in to the myDiabby application and open the "My connected objects" tab

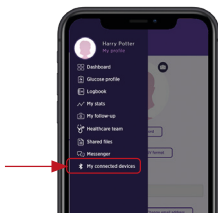

- 4** Select "Connect my capillary blood glucose meter", then "MYLIFE Unio". Click on the "Connect my health application" button

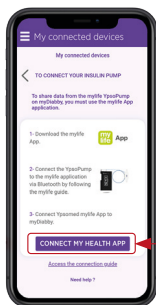
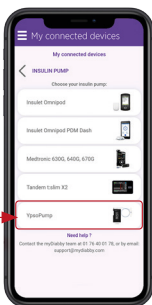
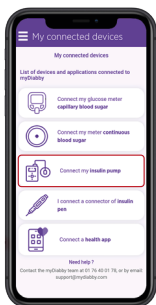

**5** Enter your mylife App account login details and confirm

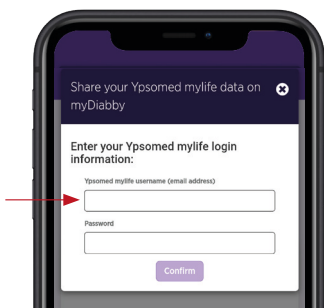

**6** The data from mylife Ypsopump is now shared on the myDiabby application!

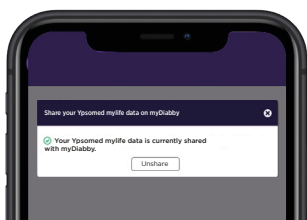

**PLEASE NOTE**

- All data entered manually or via Bluetooth in the mylife application is shared with the myDiabby application (pump data, blood sugar levels, meals, etc.).
- The data is sent regularly from the mylife application to the myDiabby application. Therefore, there may sometimes be a small delay in synchronization on the myDiabby application, which is quite normal.

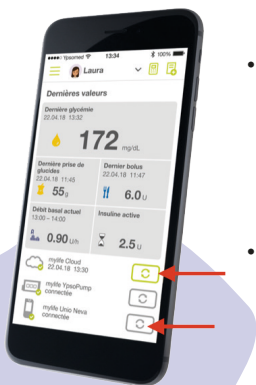

GCUNV02D20241601EN

If you have any questions about the myDiabby application:  
[support@mydiabby.com](mailto:support@mydiabby.com) or by phone

France : 01 76 40 01 78  
Belgique : 02 320 11 96



MDHC SAS  
66 avenue des Champs Elysées  
75008 Paris  
FRANCE

\*The manual is available for download and consultation on the myDiabby Healthcare platform.

